

Courses & distances down Bald Eagle cr.

North	80.7
N15E	21.
N32E	18
N46E	28½
N65½E	25
N54E	9
N30E	26
N61E	24½
N10E.	17

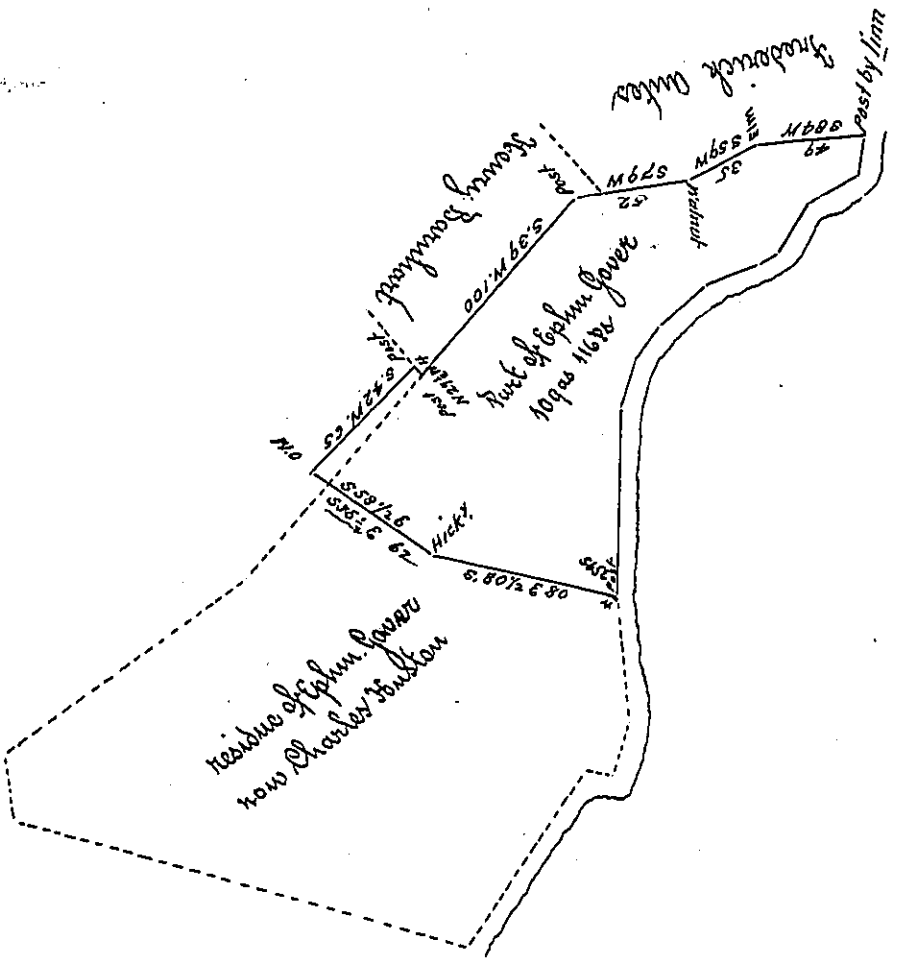

Courses & distances

S39W	100
N29½W	1
S42N	65
S58½E	62
S80½E	80
S65E	4
North	80.7
N15E	21.
N32E	18
N46E	28½
N65½E	25
N54E	9
N30E	26
N61E	24½
N10E	17
S84W	49
S59W	35
S79W	52

Situate in Roggs Township Centre County containing one hundred & nine acres and one hundred and sixteen perches and allowance of six per cent (being part of a tract of land surveyed for Ephraim Gower the 18 day of July 1769 pursuant to his order of survey No. 556 dated the 3rd day of April 1769) divided as above the 7th day of August 1828 for John Holt

G. Heister Esq.
Surveyor Genl.

J. B. Shugert

Note the small piece on the west of the dotted line is part of Joseph Hopkins Jr.

IN TESTIMONY that the above is a copy of the original remaining on file in the Department of Internal Affairs of Pennsylvania, made conformably to an Act of Assembly approved the 16th day of February, 1833, I have hereunto set my Hand and caused the Seal of said Department to be affixed at Harrisburg, this twenty-third day of February 1904

Geo. P. Brown
Secretary of Internal Affairs.